

:: MOUNTING PLATE - TERMINAL BOX

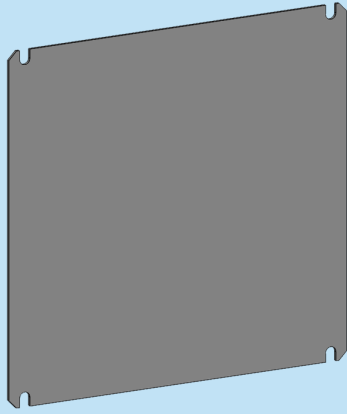

ORDER NO	TYPE	DESCRIPTION	DIMENSIONS (WxH)mm	THICKNESS	QTY
773 230	MP-TNB 1.5.1.5	Mounting Plate - Terminal Box	150x150	2.0mm	01
773 234	MP-TNB 1.5.3	Mounting Plate - Terminal Box	150x300	2.0mm	01
773 233	MP-TNB 1.75.1.75	Mounting Plate - Terminal Box	175x175	2.0mm	01
773 231	MP-TNB 2.2	Mounting Plate - Terminal Box	200x200	2.0mm	01
773 235	MP-TNB 2.3	Mounting Plate - Terminal Box	200x300	2.0mm	01
773 237	MP-TNB 2.4	Mounting Plate - Terminal Box	200x400	2.0mm	01
773 236	MP-TNB 3.3	Mounting Plate - Terminal Box	300x300	2.0mm	01